

Load cells

Mounting kits

MKX ®

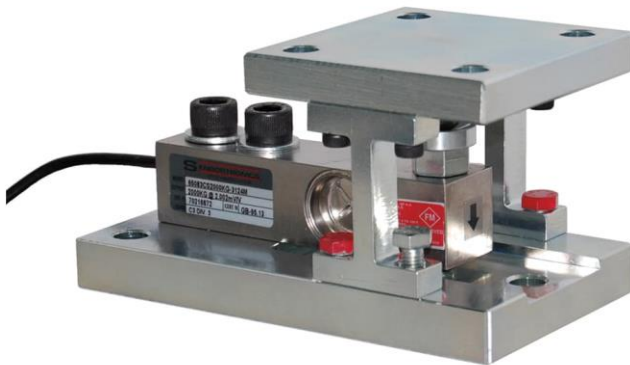

Innovative mounting system of load cells for industrial weighing systems

The kit is easily adjustable for radial and tangential mounting

Does not hinder the normal expansion and contraction of mechanical structure

Enables you to elevate the weighed structure independently without the help of a jack

Great as a template for the mechanical mounting of a weighing system

It allows height adjustment

UNIQUE, developed thanks to the know-how and experience.

TECHNICAL CHARACTERISTICS MKX®

MK0 SS:	For SB load cells 75÷250 kg Capacity
-	AISI 304 stainless steel construction
MK1 AS:	For 65023 load cells 125÷250 kg capacity
-	Nickel plated steel
MK1 SS:	For 65023 load cells 125÷250 kg capacity
-	AISI 304 stainless steel construction
MK2 AS:	For load cells 65023, 65083, 350 capacity 300 ÷ 2000 kg
-	Nickel plated steel
MK2 SS:	For load cells 65023, 65083, 350 capacity 300 ÷ 2000 kg
-	AISI 304 stainless steel construction
MK3 AS:	For 65023, 65083 load cells 3000÷5000 kg capacity
-	Nickel plated steel
MK3 SS:	For 65083 load cells 3000÷5000 kg capacity
-	AISI 304 stainless steel construction
MK4 AS:	For 350 load cells 3000÷5000 kg capacity
-	Nickel plated steel
MK4 SS:	For 350 load cells 3000÷5000 kg capacity
-	AISI 304 stainless steel construction

Load cells

Mounting kits

MKX[®]

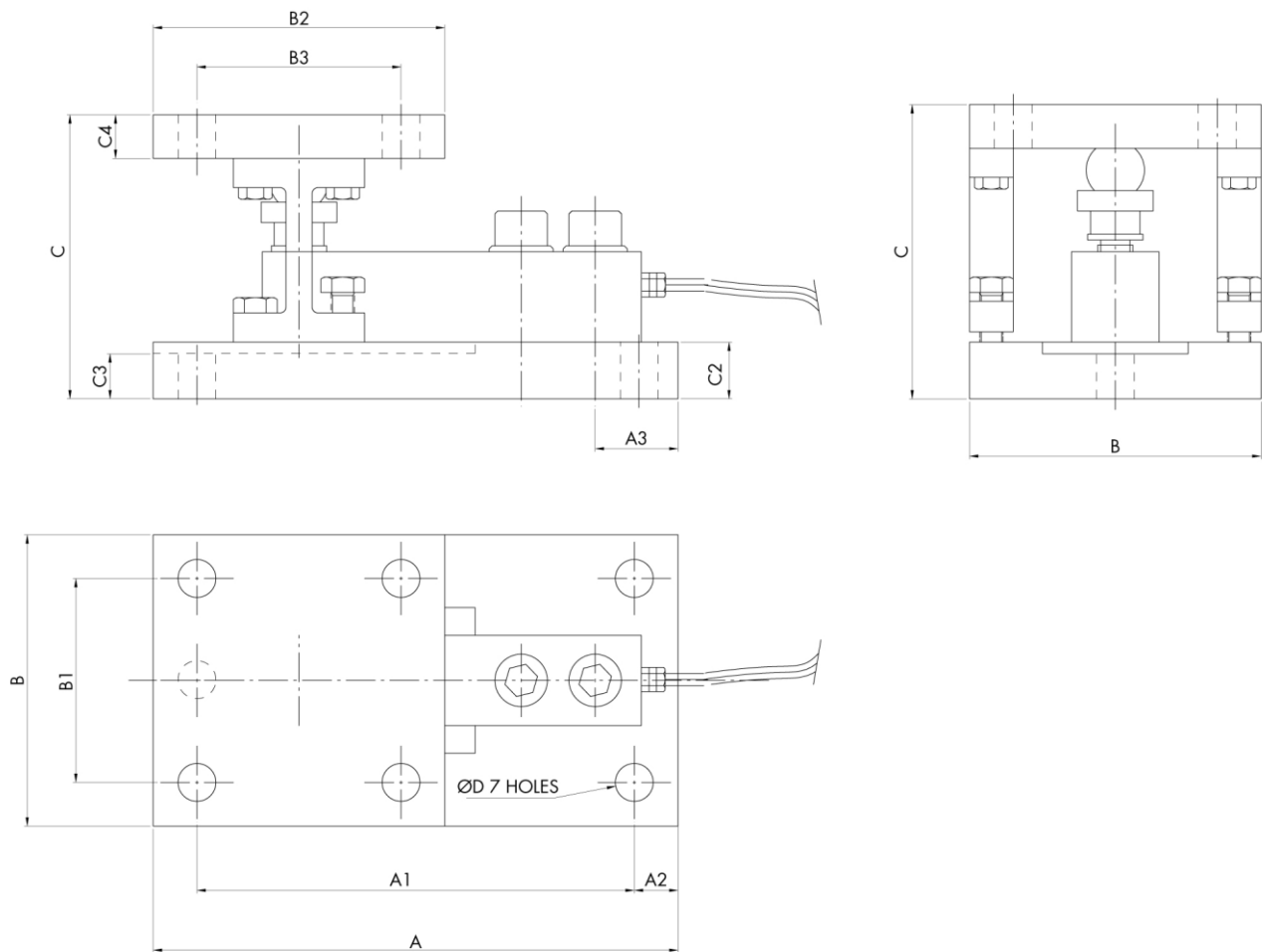

MAX LOAD IN KG

KIT	CAPACITY	TILT LOAD	SIDE LOAD
MK0 - MK1	75÷250	2000	2000
MK2	300÷2000	2000	2000
MK3 - MK4	3000÷5000	5000	5000

KIT	CAPACITY	A	A1	A2	A3	B	B1	B2	B3	C	C2	C3	C4	ØD
MK0 - MK1	75÷250	180	150	15	28,4	100	70	100	70	97,5÷100,5	19,5	15,5	15	13
MK2	300÷2000	180	150	15	28,4	100	70	100	70	97,5÷100,5	19,5	15,5	15	13
MK3	3000÷5000	250	210	20	41,6	150	110	150	110	136,5÷140	29,5	24,5	20	18
MK4	3000÷5000	250	210	20	41,6	150	110	150	110	146,5÷150	29,5	24,5	20	18